

ABS MANUAL VALVES

INDUSTRIAL EPDM DIAPHRAGM VALVE HANDWHEEL OPERATED



UNION ENDS, FPM DIAPHRAGM AVAILABLE – PRICES ON APPLICATION

SIZE	PART NO	DIA. SIZE
1/2"•	011.681.02Q	3/4"
3/4"•	011.681.03Q	3/4"
1"•	011.681.04Q	3/4"
1 1/4"•	011.681.05Q	1"
1 1/2"•	011.681.06Q	1 1/2"
2"•	011.681.07Q	1 1/2"
2 1/2"•	011.681.08Q	2"
3"•	011.681.09Q	3"
4"•	011.681.10Q	4"

INDUSTRIAL PTFE / EPDM DIAPHRAGM VALVE HANDWHEEL OPERATED



UNION ENDS, FPM DIAPHRAGM AVAILABLE – PRICES ON APPLICATION

SIZE	PART NO	DIA. SIZE
1/2"•	011.681.02S	3/4"
3/4"•	011.681.03S	3/4"
1"•	011.681.04S	3/4"
1 1/4"•	011.681.05S	1"
1 1/2"•	011.681.06S	1 1/2"
2"•	011.681.07S	1 1/2"
2 1/2"•	011.681.08S	2"
3"•	011.681.09S	3"
4"•	011.681.10S	4"

STANDARD SPRING CHECK NON RETURN VALVE – DOUBLE UNION – STAINLESS STEEL SPRING – EPDM SEALS – PLAIN ENDS

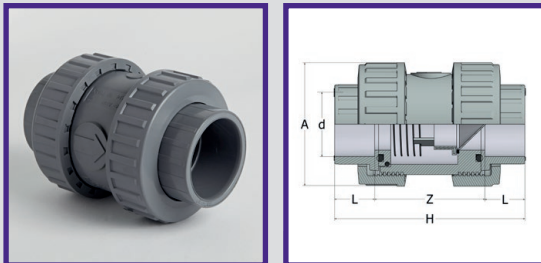

DETAILS FOR CHECK VALVE WITH PTFE COATED STAINLESS STEEL SPRING ARE AVAILABLE ON REQUEST

d	PART NO	L	Z	H	A	PN	Wt (g)	Box
3/8"	011.671.01Q	14	53	81	50	15	96	50
1/2"	011.671.02Q	16	49	81	50	15	87	50
3/4"	011.671.03Q	19	56	94	60	15	135	32
1"	011.671.04Q	22	63	107	68	15	196	22
1 1/4"	011.671.05Q	26	72	124	80	15	290	27
1 1/2"	011.671.06Q	31	84	146	96	15	476	18
2"	011.671.07Q	38	94	170	116	15	777	10
2 1/2"	011.671.08Q	44	130	218	145	10	1392	5
3"	011.671.09Q	51	148	250	166	10	2248	3
4"	011.671.10Q	61	168	290	210	10	3752	2

STANDARD SPRING CHECK NON RETURN VALVE – DOUBLE UNION – STAINLESS STEEL SPRING – FPM SEALS – PLAIN ENDS

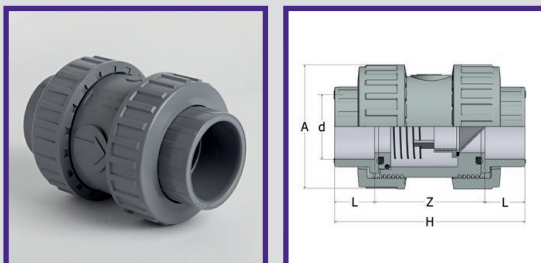

DETAILS FOR CHECK VALVE WITH PTFE COATED STAINLESS STEEL SPRING ARE AVAILABLE ON REQUEST

d	PART NO	L	Z	H	A	PN	Wt (g)	Box
3/8"	011.671.01R	14	53	81	50	15	96	50
1/2"	011.671.02R	16	49	81	50	15	87	50
3/4"	011.671.03R	19	56	94	60	15	135	32
1"	011.671.04R	22	63	107	68	15	196	22
1 1/4"	011.671.05R	26	72	124	80	15	290	27
1 1/2"	011.671.06R	31	84	146	96	15	476	18
2"	011.671.07R	38	94	170	116	15	777	10
2 1/2"	011.671.08R	44	130	218	145	10	1392	5
3"	011.671.09R	51	148	250	166	10	2248	3
4"	011.671.10R	61	168	290	210	10	3752	2

• NON COMER PRODUCT

UK Wide Next Day Delivery*

epco customers can place orders up to 5pm for next day delivery to most addresses in the UK*

ABS

PVC IMPERIAL

PVC METRIC

POLYPROPYLENE

COMPRESSION FITTINGS

GUIDELINES

