

PVC IMPERIAL MANUAL VALVES

COMPACT BALL VALVE

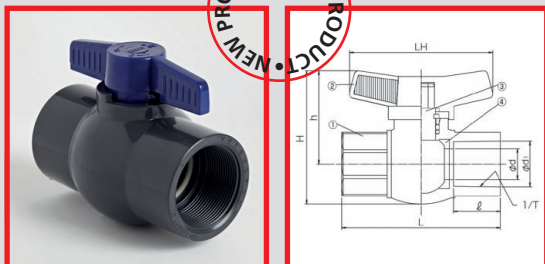
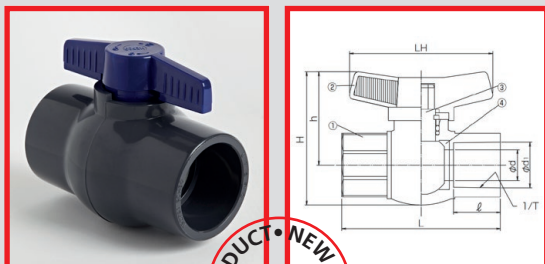

EPDM SEALS – PLAIN ENDS

d	PART NO	L	od	oDu	I	H1	HL	Wt (g)	Box
1/2"	021.641.02Q	78	15	31	22	47	70	96	100
3/4"	021.641.03Q	90	20	37	25	52	79	150	100
1"	021.641.04Q	106	23.8	44	30	65	99	250	50
1 1/4"	021.641.05Q	121	29.6	53	33	70	112	355	50
1 1/2"	021.641.06Q	130	33.8	60	35	74	112	460	24
2"	021.641.07Q	148	44.2	76	38	80	138	755	24

EPDM SEALS – THREADED ENDS

d	PART NO	L	od	oDu	I	H1	HL	Wt (g)	Box
1/2"	021.643.02Q	78	15	31	22	47	70	96	100
3/4"	021.643.03Q	90	20	37	25	52	79	150	100
1"	021.643.04Q	106	23.8	44	30	65	99	250	50
1 1/4"	021.643.05Q	121	29.6	53	33	70	112	355	50
1 1/2"	021.643.06Q	130	33.8	60	35	74	112	460	24
2"	021.643.07Q	148	44.2	76	38	80	138	755	24

VACUUM BREAKER VALVE

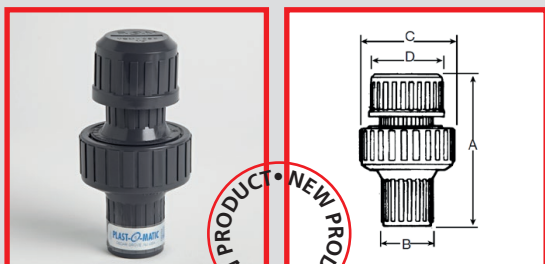

SIZE	PART NO	A"	A mm	B"	B mm	C"	C mm	D"	D mm
1/2"	021.701.02	4.3	110	1.3	33	2.4	62	1.9	48
3/4"	021.701.03	4.6	117	1.6	39	2.8	72	2.3	59
1"	021.701.04	5.1	130	1.9	48	2.8	72	2.5	64

SLIDE VALVE

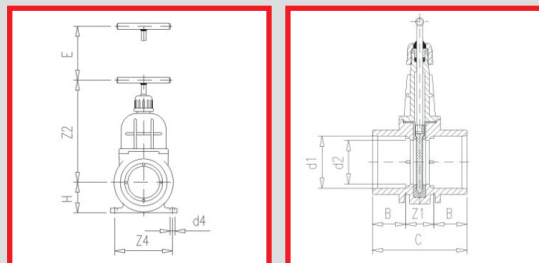

SIZE	PART NO	d2	d4	Z1	Z2	Z4	B	C	E	H	Wt (g)
1 1/2"	021.941.06Q	42	7	29	139	76	31	91	52	40	391
2"	021.941.07Q	54	9	38	164	98	38	114	65	51.5	719
3"	021.941.09Q	76	9	45	218	134	51	147	91	71	1790
4"	021.941.10Q	95	9	54	250	158	61	176	108	81	2918

SINGLE UNION PLAIN BALL CHECK VALVE



SIZE	PART NO	D	D1	L	L1	Wt (g)	Box
1/2"	021.831.02Q	58	26	98		13	200
3/4"	021.831.03Q	58	32	104	34	13	200
1"	021.831.04Q	58	39	108.5	40	14	200
1 1/4"	021.831.05Q	102	56	165	55	62	24
1 1/2"	021.831.06Q	102	56	165	55	57	24
2"	021.831.07Q	102	69	155	68	62	24

• NON COMER PRODUCT

UK Wide Next Day Delivery*

epco customers can place orders up to 5pm for next day delivery to most addresses in the UK*

ABS

PVC IMPERIAL

PVC METRIC

POLYPROPYLENE

COMPRESSION FITTINGS

GUIDELINES

